

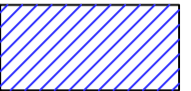

LEGEND	
	NEW AREA ADDED
	INTERNAL CHANGE AREA
	SANCTION AREA NOT CONSTRUCTED



- NOTES:
- ALL LFTS SHALL HAVE 100% POWER BACKUP.
 - THE BUILDING SHALL BE CONSIDERED A MECHANICALLY VENTILATED.
 - ALL ELECTRICAL INSTALLATIONS SHALL BE AS PER PROVISIONS OF NBC.
 - FIRE SAFETY PROCEDURES SHALL BE AS PER RELEVANT CODES.
 - BASEMENT AREA SHALL HAVE MECHANICALLY VENTILATED AS PER RELEVANT CODE.
 - ALL FLEETS ARE VENTILATED AS PER HANDBOOK BUILDING CODE 2011.
 - BUILDING HAS AUTOMATIC SPRINKLER SYSTEM WHEREVER REQUIRED BY NBC.
 - BUILDING SHALL BE DESIGNATED STRUCTURE AS PER RELEVANT CODES FOR EARTHQUAKE RESISTANCE.
 - THE RESPONSIBILITY OF STRUCTURE DESIGN AND STRUCTURE STABILITY OF BUILDING AGAINST THE EARTHQUAKE SHALL BE ENTIRELY OF THE STRUCTURE ENGINEER ARCHITECTONER.
 - THE SANITARY WASTE REMOVAL SYSTEM SHALL BE PROVIDED AS PER CENTRAL GROUND WATER AUTHORITY NORMS.
 - SOLAR PANELS OF REQUIRED CAPACITY SHALL BE PROVIDED ON ROOF TOP AS PER THE COLLECTOR OWNER SHALL USE ONLY LIGHT EMITTING DIODE LAMP/FITTING FOR INTERNAL LIGHTING AS WELL AS GARDEN LIGHTING.
 - ALL HANDICAP RAMP WITH RAILINGS.

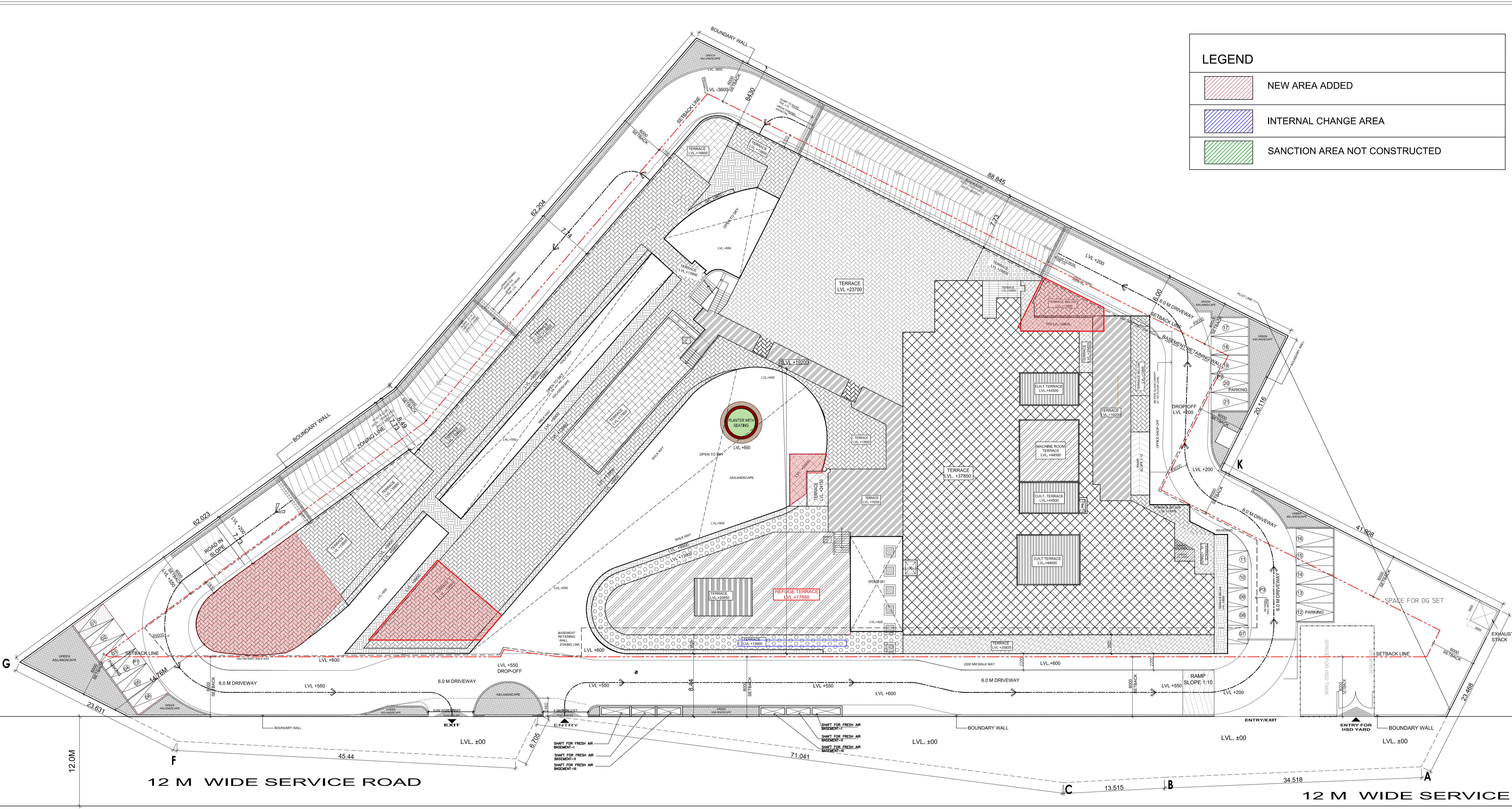
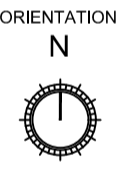

PRINCIPAL ARCHITECT:

ACPL ISO 9001:2008
Architecture Management Planning

ACPL Design Ltd. E-24, South Extension - III, 4th Fl., 24622705 New Delhi 110048, India. +91 11 24622704
E: contact@acplindia.com P: +91 11 24622705

PROJECT:-
REVISED BUILDING PLAN OF COMMERCIAL COLONY MEASURING 2.71875 Acres (LICENSE NO. 72 OF 2013 DATED 27-07-2013) IN SECTOR - 92, GURGAON MANESAR URBAN COMPLEX BEING DEVELOPED BY M/S SPAZE TOWERS PVT.LTD.

OWNER/AUTH. SIGNATURE	ARCHITECT'S SIGNATURE
DRAWING TITLE	SITE PLAN (ARCHITECTURE)
DRAWING NO. 01	SCALE : 1:200