

Office Floors	Covered Area	Occupancy Load	Total Occupancy	Staff / Population	Male (M)	Female (F)	Finishing Population	Required	Proposed
Second Floor	1314 sq. meters	As per NBC 2005	132	131	66	65	139	Male	Male
WC				13	6	7	75	Female	Female
Wardrooms				1	1	1	4	Male	Male
				1	1	1	4	Female	Female
				1	1	1	4	Male	Male
				1	1	1	4	Female	Female

Checked and found ok for Public Health (Utility services) subject to compliance of 4/3/19  
 Approved by Engineer (PH)  
 HSRP, Chandigarh  
 4/3/19

ADFO (HQ)  
 DRS PTL  
 Member BPC  
**DINESH KUMAR SD (HQ)**

DESCRIPTION	LEGEND
SOIL, WASTE & VENT PIPE	①-④
SOIL AND VENT PIPE	①
WASTE AND VENT PIPE	②
RAIN WATER PIPE FOR TERRACE	③
RAIN WATER PIPE FOR BALCONY	④
C.W.S. DROP FROM O.H.T.	⑤
C.W.S. RISER TO O.H.T.	⑥
F.W.S. DROP FROM O.H.T.	⑦
F.W.S. RISER TO O.H.T.	⑧
SOFT WATER SUPPLY RISER TO O.H.T.	⑨
H.W.S. DROP FROM SOLAR TANK	⑩
FLOOR TRAP	FT
DRAIN POINT	DP
SHOWER	SH
SOIL PIPE	SP
WASTE PIPE	WP

S.NO.	TYPE	SIZE (IN MM)	LINTEL
1	F01	1200	2400
2	F02	1000	2400
3	D1	1200	2100
4	D1A	1200	2100
5	D2	1400	2100
6	D3	1000	2100
7	D4	750	2100
8	D5	600	2100
9	G11	1400	2400
10	G12	1200	2400
11	S11	1000	2100
12	FG1	-	-

This is a PROVISIONAL APPROVED BUILDING PLAN for purpose of inviting tenders for construction from the general public  
 Architect (HO)  
 Directorate of Town and Country Planning,  
 Haryana, Chandigarh

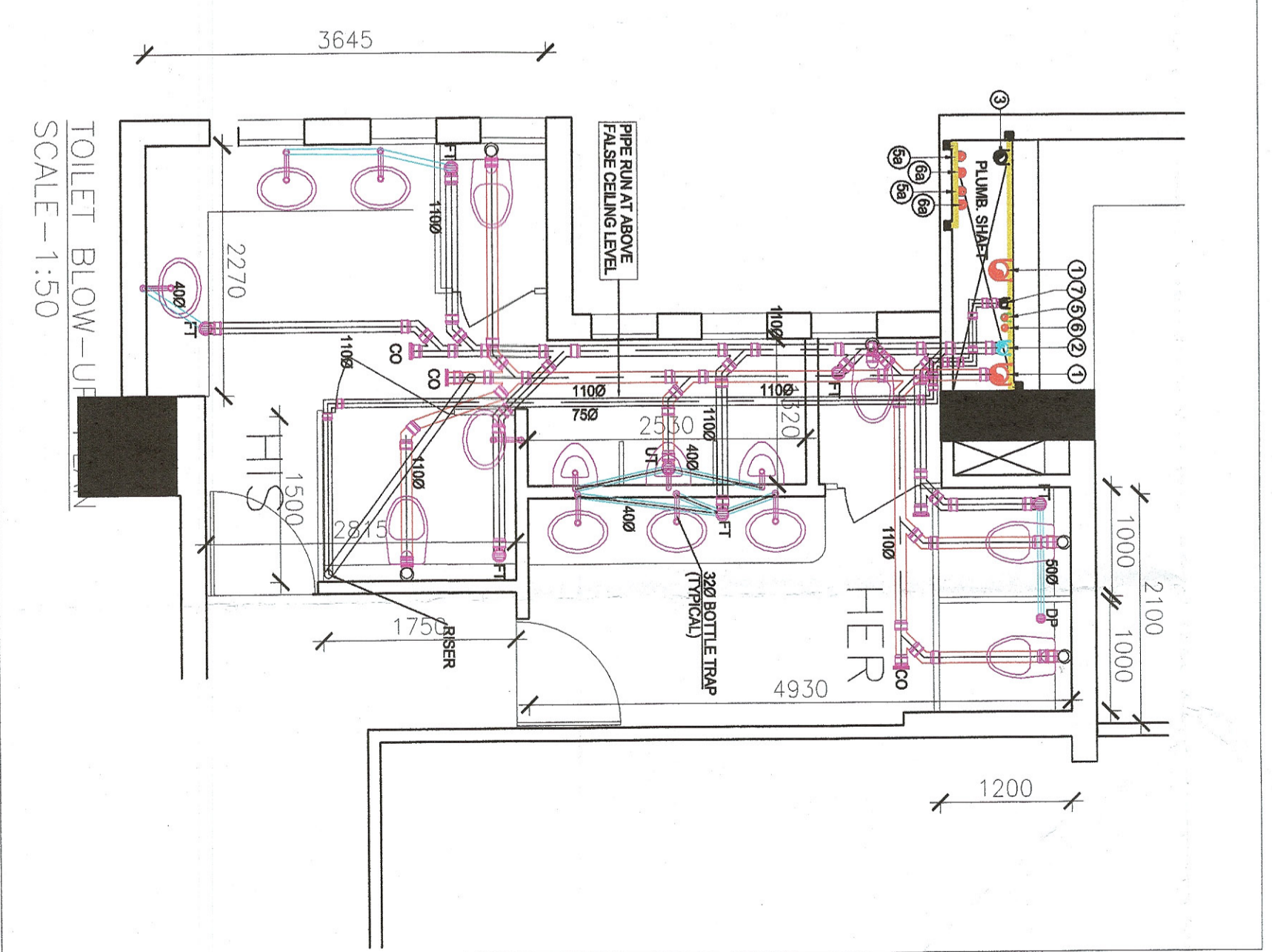
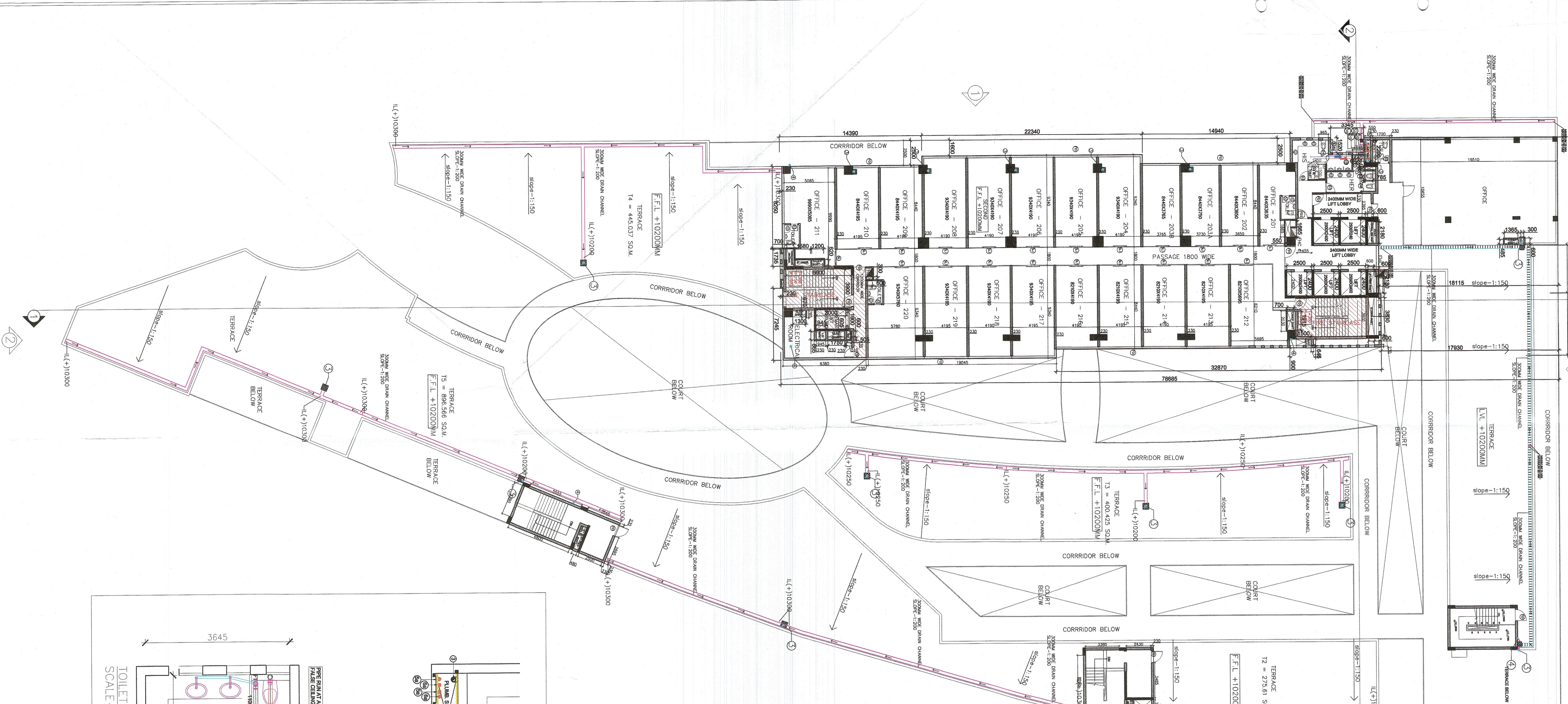

**ACPL**  
 ARCHITECTS  
 602 30012008  
 108, Sector 29, Chandigarh

PROJECT:  
 REVISED BUILDING PLAN OF COMPOUND WALL AND MESS BUILDING 32/2722 IN SECTOR - 78, DISTT - GURGAON, HARYANA, URBAN COMPLEX BEING DEVELOPED BY HARYANA URBAN COLLABORATION WITH SPZLE TOWERS PVT. LTD.

ACPL Design Ltd  
 C-26, Sector 29, Chandigarh  
 www.acpldesign.com

FOR SPACE TOWERS PVT. LTD.  
 AUTHORIZED SIGNATORY  
 ARCHITECT'S SIGNATURE

DRAWING NO. S-07 SCALE: 1:200