

**AREA STATEMENT FOR 4TH & 5TH FLOOR**

1	8,365	X	8,870	=	74,197	sq. mts
2	10,450	X	9,100	=	95,005	sq. mts
3	19,715	X	23,815	=	468,589	sq. mts
4	20,435	X	4,800	=	98,022	sq. mts
5	6,835	X	22,945	=	156,829	sq. mts
6	6,480	X	23,175	=	149,710	sq. mts
7	6,240	X	22,825	=	142,459	sq. mts
TOTAL AREA (A)				=	1178,88	sq. mts

**DEDUCTIONS (D)**

A	4	X	2,400	X	2,500	=	24,000	sq. mts
B	0.60	X	2,245	=	1,347	sq. mts		
C	0.60	X	1,835	=	1,101	sq. mts		
D	0.60	X	2,060	=	1,236	sq. mts		
E	2,400	X	1,140	=	2,736	sq. mts		
F	1,450	X	0,750	=	1,087	sq. mts		
G	0,875	X	0,550	=	0,481	sq. mts		
H	6,300	X	0,600	=	3,810	sq. mts		
I	2,400	X	0,600	=	1,437	sq. mts		
J	6,595	X	0,600	=	5,391	sq. mts		
TOTAL AREA (A)				=	42,266	sq. mts		
TOTAL FLOOR AREA = (A - D) = (1178.88 - 42.266)				=	1136.62	sq. mts		

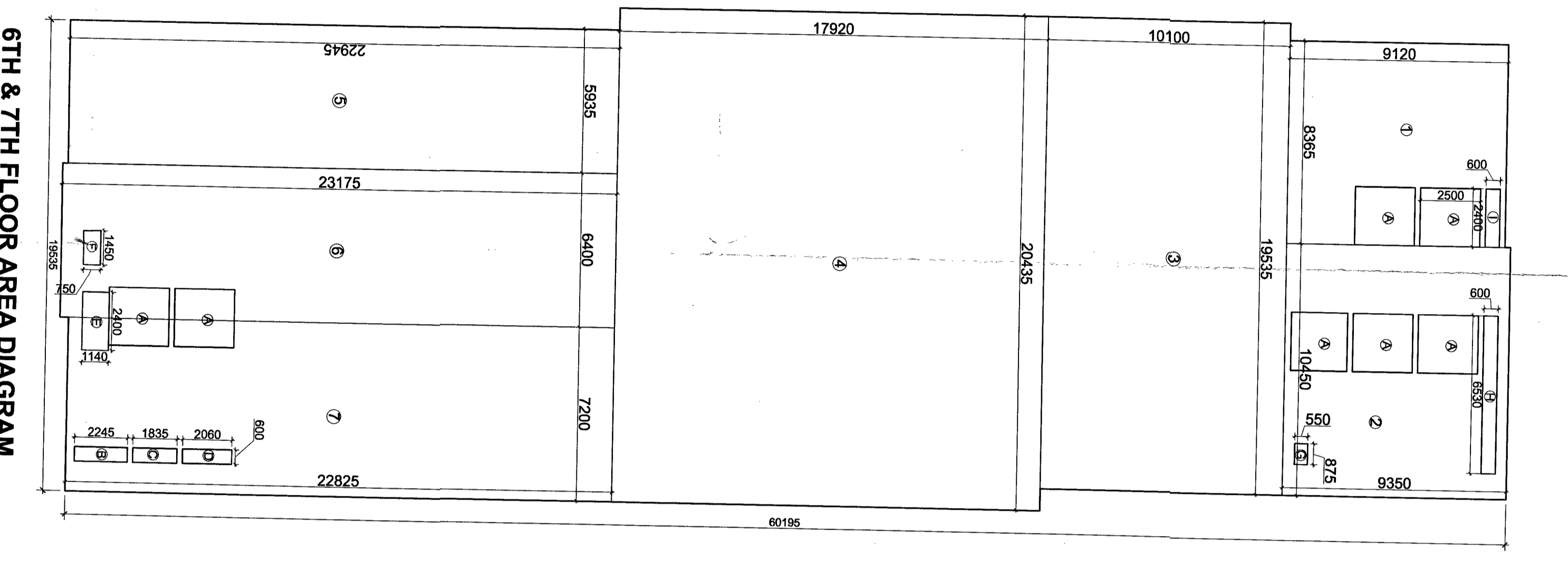

**AREA STATEMENT FOR 6TH & 7TH FLOOR**

1	8,365	X	9,120	=	76,288	sq. mts
2	10,450	X	9,360	=	97,797	sq. mts
3	19,715	X	10,100	=	197,203	sq. mts
4	20,435	X	17,620	=	361,195	sq. mts
5	6,835	X	22,945	=	156,178	sq. mts
6	6,400	X	23,175	=	148,32	sq. mts
7	6,400	X	22,825	=	144,34	sq. mts
TOTAL AREA (A)				=	1168,331	sq. mts

**DEDUCTIONS (D)**

A	4	X	2,400	X	2,500	=	24,000	sq. mts
B	0.60	X	2,245	=	1,347	sq. mts		
C	0.60	X	1,835	=	1,101	sq. mts		
D	0.60	X	2,060	=	1,236	sq. mts		
E	2,400	X	1,140	=	2,736	sq. mts		
F	1,450	X	0,750	=	1,087	sq. mts		
G	0,875	X	0,550	=	0,481	sq. mts		
H	6,300	X	0,600	=	3,810	sq. mts		
I	2,400	X	0,600	=	1,437	sq. mts		
TOTAL AREA (A)				=	37,235	sq. mts		
TOTAL FLOOR AREA = (A - D) = (1168.331 - 37.235)				=	1131.096	sq. mts		

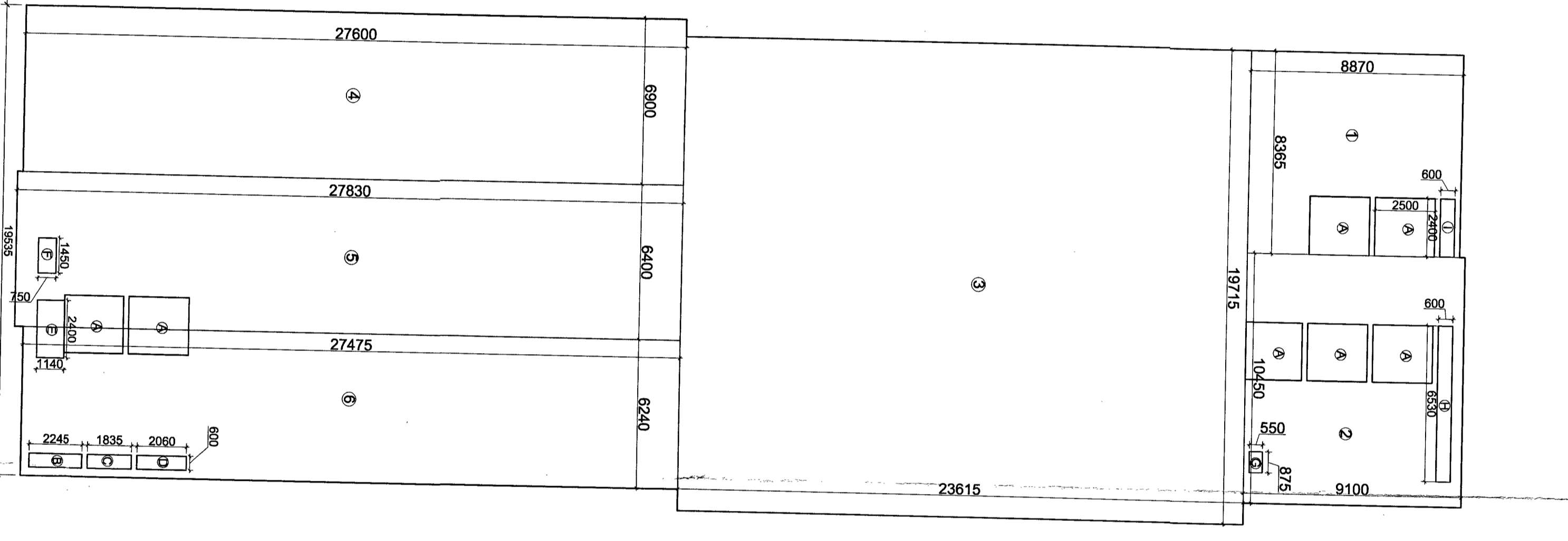

**AREA STATEMENT FOR 8TH & 9TH FLOOR**

1	8,365	X	8,870	=	74,197	sq. mts
2	10,450	X	9,100	=	95,005	sq. mts
3	19,715	X	23,815	=	468,589	sq. mts
4	6,800	X	27,600	=	188,44	sq. mts
5	6,400	X	27,630	=	176,112	sq. mts
6	6,240	X	27,475	=	171,444	sq. mts
TOTAL AREA (A)				=	1174,857	sq. mts

**DEDUCTIONS (D)**

A	4	X	2,400	X	2,500	=	24,000	sq. mts
B	0.60	X	2,245	=	1,347	sq. mts		
C	0.60	X	1,835	=	1,101	sq. mts		
D	0.60	X	2,060	=	1,236	sq. mts		
E	2,400	X	1,140	=	2,736	sq. mts		
F	1,450	X	0,750	=	1,087	sq. mts		
G	0,875	X	0,550	=	0,481	sq. mts		
H	6,300	X	0,600	=	3,810	sq. mts		
I	2,400	X	0,600	=	1,437	sq. mts		
TOTAL AREA (A)				=	37,235	sq. mts		
TOTAL FLOOR AREA = (A - D) = (1174.857 - 37.235)				=	1137,622	sq. mts		

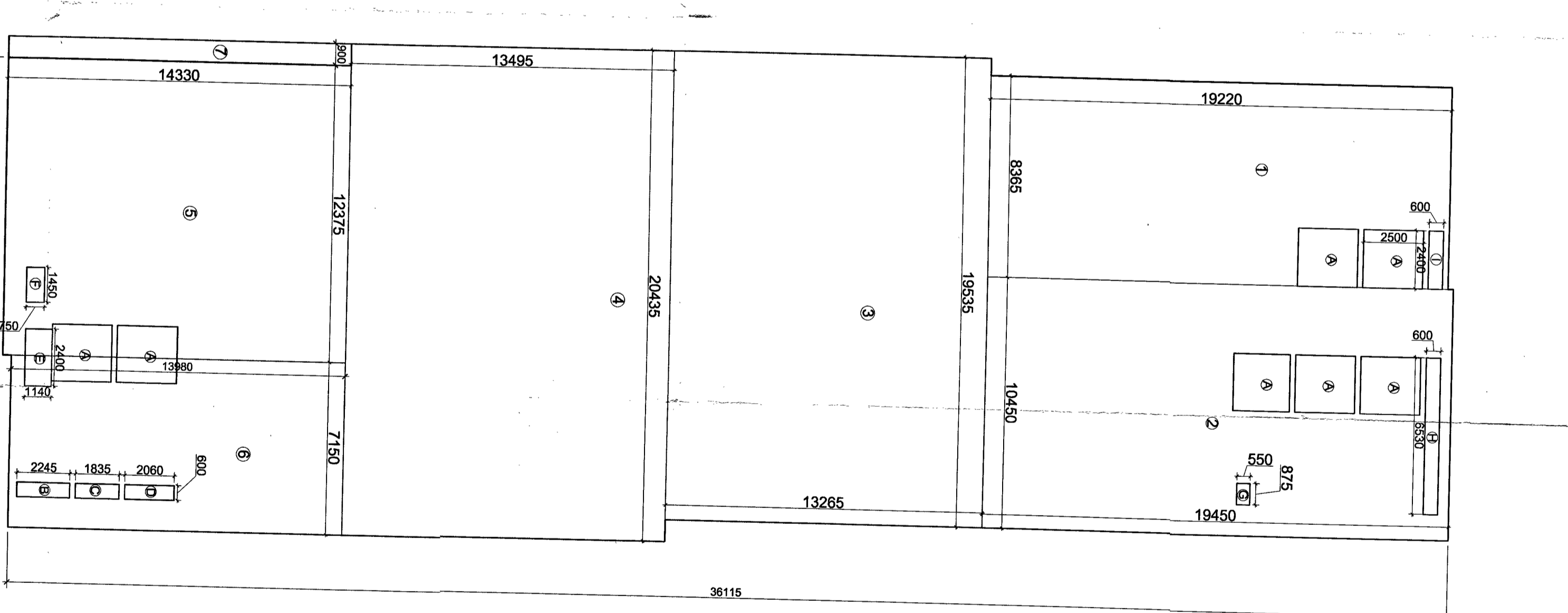

**AREA STATEMENT FOR 10TH & 11TH FLOOR**

1	8,365	X	19,420	=	160,775	sq. mts
2	10,450	X	19,450	=	203,252	sq. mts
3	19,535	X	13,265	=	259,131	sq. mts
4	20,435	X	13,495	=	275,770	sq. mts
5	12,375	X	14,330	=	177,333	sq. mts
6	7,150	X	13,980	=	99,857	sq. mts
7	0,900	X	14,330	=	12,897	sq. mts
TOTAL AREA (A)				=	1193,115	sq. mts

**DEDUCTIONS (D)**

A	4	X	2,400	X	2,500	=	24,000	sq. mts
B	0.60	X	2,245	=	1,347	sq. mts		
C	0.60	X	1,835	=	1,101	sq. mts		
D	0.60	X	2,060	=	1,236	sq. mts		
E	2,400	X	1,140	=	2,736	sq. mts		
F	1,450	X	0,750	=	1,087	sq. mts		
G	0,875	X	0,550	=	0,481	sq. mts		
H	6,300	X	0,600	=	3,810	sq. mts		
I	2,400	X	0,600	=	1,437	sq. mts		
TOTAL AREA (A)				=	37,235	sq. mts		
TOTAL FLOOR AREA = (A - D) = (1193.115 - 37.235)				=	1155,88	sq. mts		

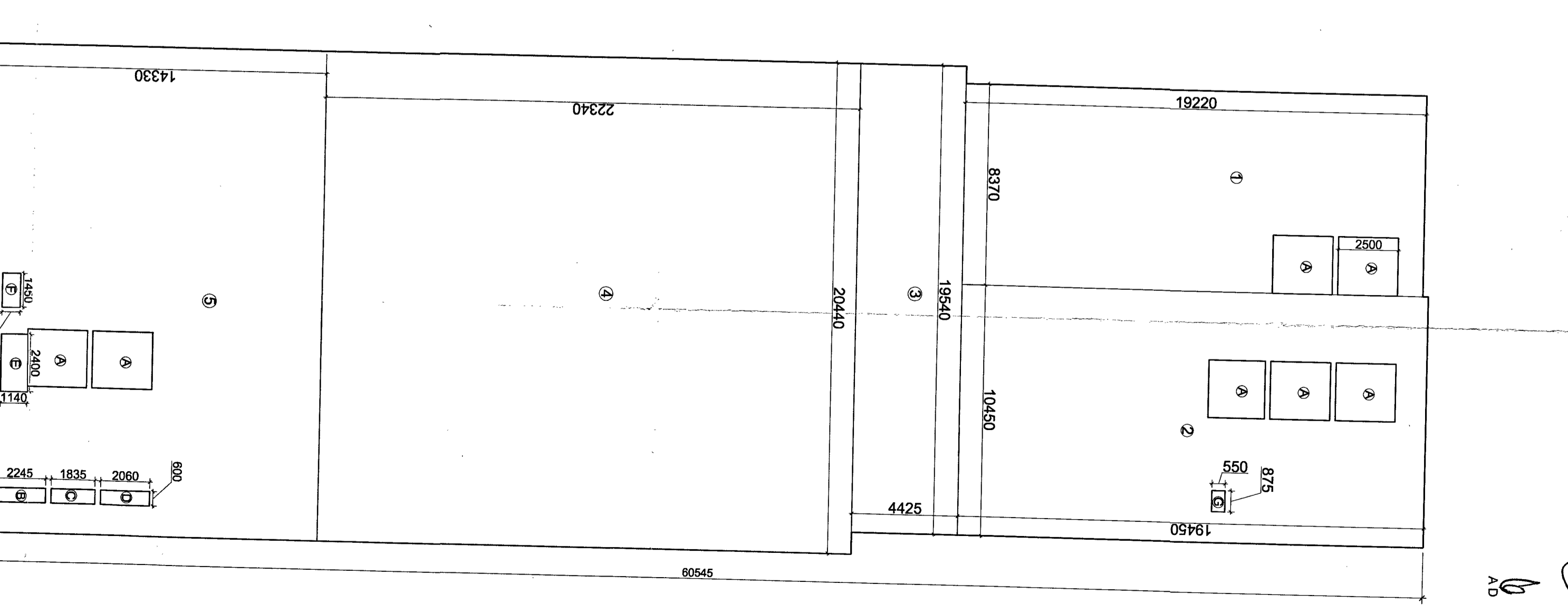

**AREA STATEMENT FOR 12TH FLOOR**

1	8,370	X	19,220	=	160,971	sq. mts
2	10,450	X	19,450	=	203,252	sq. mts
3	19,440	X	4,425	=	86,464	sq. mts
4	20,335	X	22,340	=	454,629	sq. mts
5	20,335	X	14,330	=	292,905	sq. mts
TOTAL AREA (A)				=	1200,121	sq. mts

**DEDUCTIONS (D)**

A	4	X	2,400	X	2,500	=	24,000	sq. mts
B	0.60	X	2,245	=	1,347	sq. mts		
C	0.60	X	1,835	=	1,101	sq. mts		
D	0.60	X	2,060	=	1,236	sq. mts		
E	2,400	X	1,140	=	2,736	sq. mts		
F	1,450	X	0,750	=	1,087	sq. mts		
G	0,875	X	0,550	=	0,481	sq. mts		
TOTAL AREA (A)				=	31,888	sq. mts		
TOTAL FLOOR AREA = (A - D) = (1200.121 - 31.888)				=	1168,233	sq. mts		

**SANCTIONED**  
 In Accordance with  
 Municipal Ordinance No. 2013-2013-13

PROCESSED BUILDING PLAN OF COMMERCIAL BUILDING ON THE LAND  
 BEING REVENUE COVERED BY SHAWA SINDHI IN COLLABORATION WITH SPAVE  
 DRAWING NO. 11/10

**AREA CALCULATION** SCALE: 1:100

ARCHITECTS: SHAIKHA GABRIELI & PARTNERS  
 ARCHITECTS SIGN: [Signature]

CONTRACTOR SIGN: [Signature]

DATE: 11/10

PROJECT NO: 9