

AREA STATEMENT FOR BASEMENT 1

Sl. No.	Description	Area (sq. m)
1	1	2720
2	2	15635
3	3	15635
4	4	15635
5	5	15635
6	6	15635
7	7	15635
8	8	15635
9	9	15635
10	10	15635
11	11	15635
TOTAL AREA OF PARKING (A, B, C, D, E, F, G, H, I, J, K, L, M, N)		114779
TOTAL AREA OF BASEMENT 1		114779

AREA STATEMENT FOR BASEMENT 2

Sl. No.	Description	Area (sq. m)
1	1	2720
2	2	15635
3	3	15635
4	4	15635
5	5	15635
6	6	15635
7	7	15635
8	8	15635
9	9	15635
10	10	15635
11	11	15635
TOTAL AREA OF PARKING (A, B, C, D, E, F, G, H, I, J, K, L, M, N)		114779
TOTAL AREA OF BASEMENT 2		114779

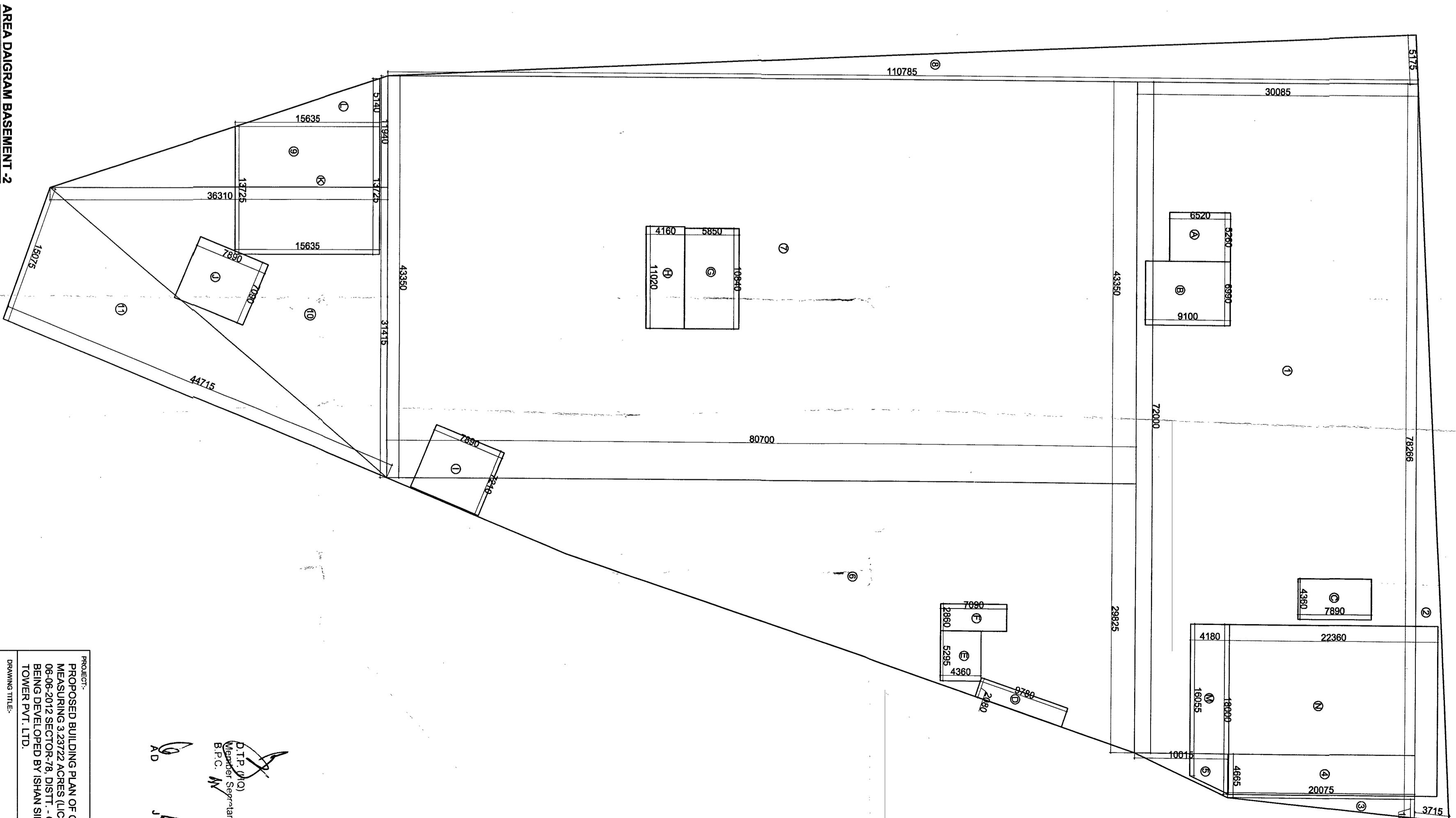
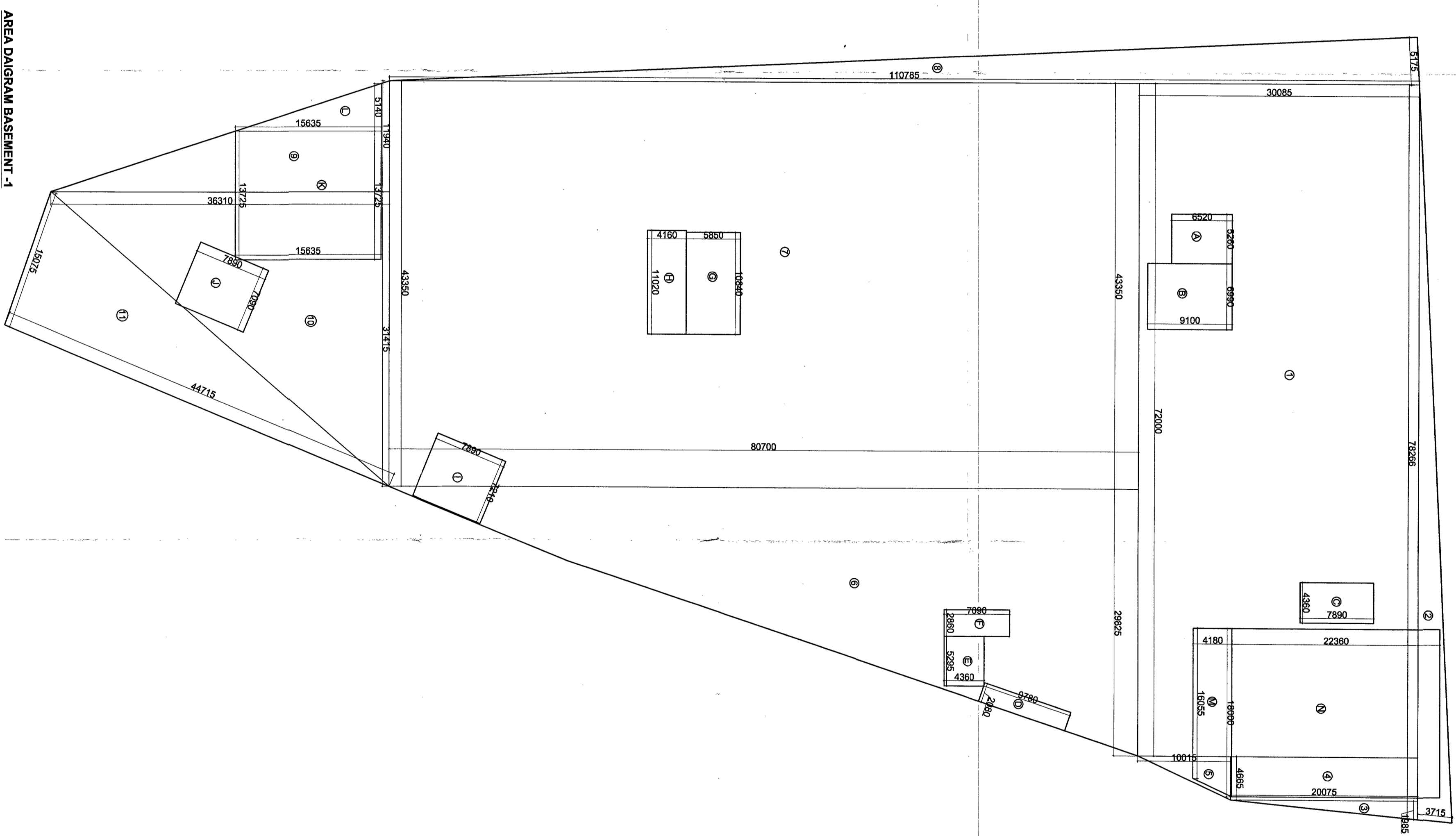

PROPOSED BUILDING PLAN FOR COMMERCIAL COMPLEX ON THE LAND
 NO. 27/2017/2013, AREA 10.00 SQ. M, OF 2017 DATED
 15/08/2017, AT CHENNAI. THE PLAN IS PREPARED BY
 ARCHITECTS SIGNATURE AND SEAL IN CONFORMANCE WITH
 TOWN AND COUNTRY PLANNING ACT, 1962 AND
 TOWN AND COUNTRY PLANNING (AMENDMENT) ACT, 1965.

BASEMENT PLAN 1:200

ARCHITECTS SIGNATURE AND SEAL

ARCHITECTS SIGNATURE AND SEAL

ARCHITECTS SIGNATURE AND SEAL