



LEGEND	
	NEW AREA ADDED
	INTERNAL CHANGE AREA
	SANCTION AREA NOT CONSTRUCTED



- NOTES
- ALL LIFTS SHALL HAVE 100% POWER BACK-UP.
  - THE BUILDING IS FULLY AIR CONDITIONED & MECHANICALLY VENTILATED.
  - ALL ELECTRICAL INSTALLATIONS SHALL BE AS PER PROVISIONS OF NBC.
  - FIRE FIGHTING / SAFETY PROVISIONS WILL BE AS PER RELEVANT NBC PROVISIONS.
  - BASEMENT AREA SHALL HAVE MECHANICALLY VENTILATED AS PER RELEVANT CODE.
  - ALL TOILETS ARE VENTILATED AS PER HARYANA BUILDING CODE 2017.
  - BUILDING HAS AUTOMATIC SPRINKLER SYSTEM AS REQUIRED BY NBC.
  - BUILDING WILL BE DESIGNED (STRUCTURES) AS PER RELEVANT I.S. CODES FOR EARTHQUAKE RESISTANCE.
  - THE RESPONSIBILITY OF STRUCTURE DESIGN AND STRUCTURE STABILITY OF BUILDING AGAINST THE SEISMOLOGICAL SHALL BE ENTIRELY OF THE STRUCTURE ENGINEER ARCHITECT/OWNER.
  - THE RAIN WATER HARVESTING SYSTEM SHALL BE PROVIDED AS PER CENTRAL GROUND WATER AUTHORITY NORMS.
  - SOLAR PANELS OF REQUIRED CAPACITY SHALL BE PROVIDED ON ROOF TOP AS PER THE COLONIZER/OWNER SHALL USE ONLY LIGHT-EMITTING DIODE (LAMP/LED) FITTING FOR INTERNAL LIGHTING AS WELL AS CAMPUS LIGHTING.
  - ALL HANDICAP RAMP WITH RAILING.

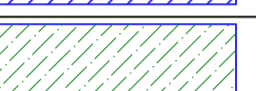
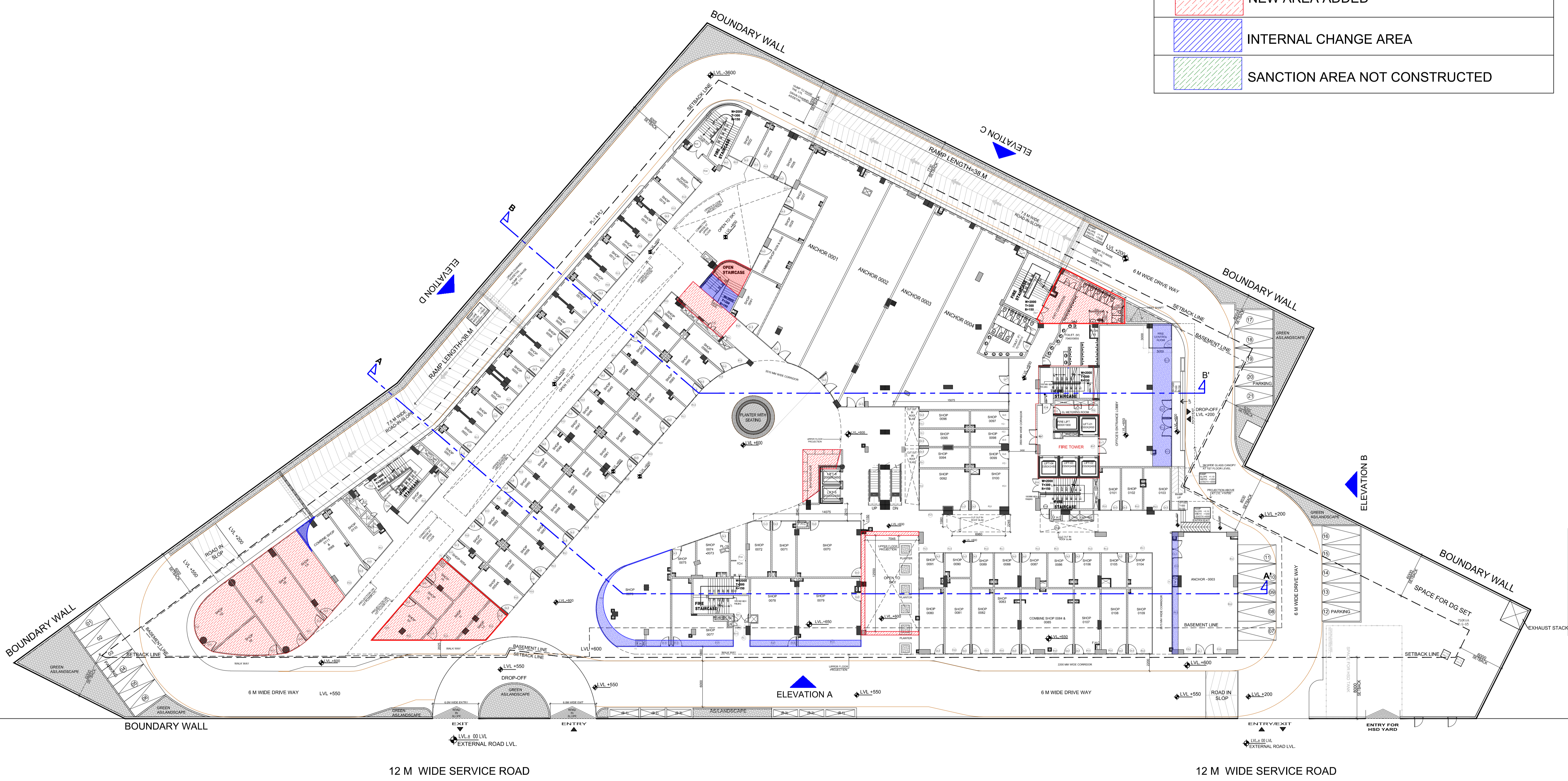
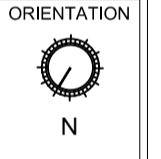

PRINCIPAL ARCHITECT:

**ACPL** ISO 9001:2008  
Architecture Management Planning

ACPL Design Ltd E-24 South Extension - IV, Plot No. 11, Sector 14, Gurgaon, Haryana  
www.acpl.in  
E. contact@acpl.in P. 011 2622195

PROJECT:-  
REVISED BUILDING PLANS FOR  
COMMERCIAL COLONY MEASURING 2.71875 Acres  
( LICENCE NO. 72 OF 2013 DATED 27-07-2013 )  
IN SECTOR-92, GURGAON MANESAR URBAN COMPLEX  
BEING DEVELOPED BY M/s SPAZE TOWERS PVT.LTD.

OWNER/AUTH. SIGNATURE ARCHITECT'S SIGNATURE

DRAWING TITLE  
GROUND FLOOR PLAN

DRAWING NO. 05 SCALE :- 1:200