

LEGEND	
	NEW AREA ADDED
	INTERNAL CHANGE AREA
	SANCTION AREA NOT CONSTRUCTED

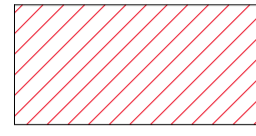

- NOTES:
- ALL LIFTS SHALL HAVE 100N POWER BACK UP.
  - THE BUILDING IS SEELY AIRCONDITIONED AND MECHANICALLY VENTILATED.
  - ALL ELECTRICAL INSTALLATIONS SHALL BE AS PER PROVISIONS OF NBC.
  - ALL FIRE FIGHTING SAFETY PROVISIONS WILL BE AS PER RELEVANT NBC PROVISIONS.
  - BASEMENT AREA SHALL HAVE MECHANICALLY VENTILATED AS PER RELEVANT NBC.
  - ALL TOILETS ARE VENTILATED AS PER RELEVANT BUILDING CODE 2022.
  - BUILDING HAS AUTOMATIC SPRINKLER SYSTEM WHEREVER REQUIRED BY NBC.
  - BUILDING WILL BE DESIGNED STRUCTURES AS PER RELEVANT I.C. CODES FOR EARTHQUAKE RESISTANCE.
  - THE RESPONSIBILITY OF STRUCTURE DESIGN AND STRUCTURE STABILITY OF BUILDING AGAINST THE EARTHQUAKE SHALL BE ENTIRELY OF THE STRUCTURE ENGINEER/ ARCHITECTS/OWNER.
  - THE RAIN WATER HARVESTING SYSTEM SHALL BE PROVIDED AS PER CENTRAL GROUND WATER AUTHORITY NORMS.
  - SOLAR PANELS OF REQUIRED CAPACITY SHALL BE PROVIDED ON ROOF TOP AS PER THE CONSULTING ENGINEER SHALL USE ONLY LIGHT EMITTING DIODE (LED) LIGHTING FITTING FOR RETAILING LIGHTING AS WELL AS CAMPUS LIGHTING.
  - ALL HANDICAP RAMP WITH RAMPING.

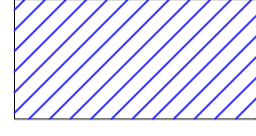
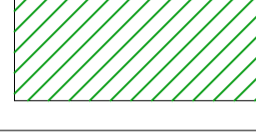
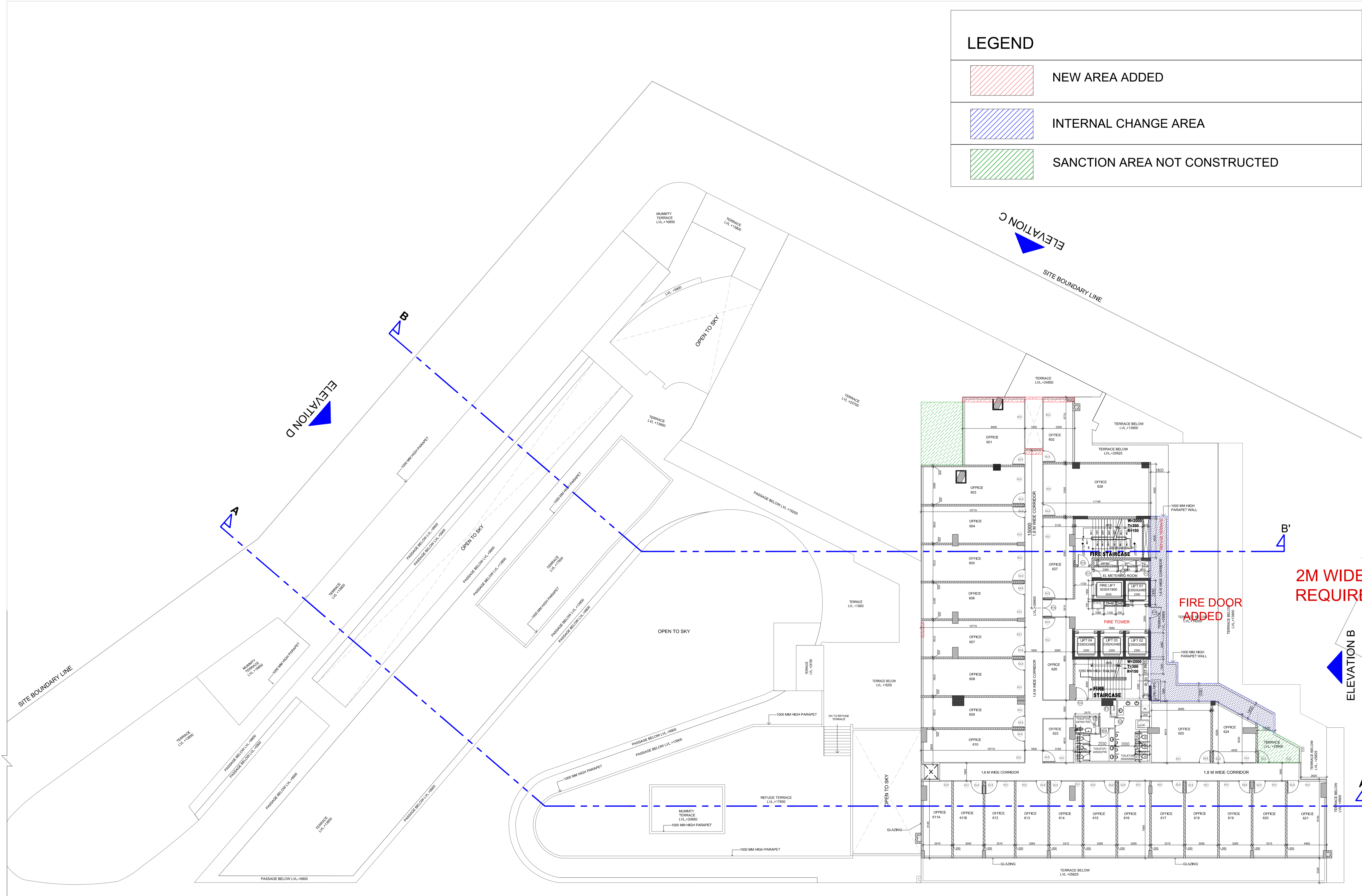
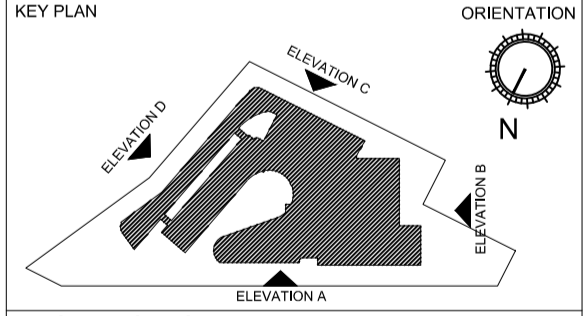

PRINCIPAL ARCHITECT:

**ACPL** 900 9000 3008  
Architecture  
Planning

ACPL Design Ltd. 4/2, Park Avenue, 11th, 12th Floor  
11, Park Avenue, 11th, 12th Floor

PROJECT:-  
REVISED BUILDING PLANS FOR  
COMMERCIAL COLONY MEASURING 2.71875 Acres  
(LICENCE NO. 72 OF 2013 DATED 27-07-2013 )  
IN SECTOR-82,GURGAON MANESAR URBAN COMPLEX  
BEING DEVELOPED BY M/s SPAZAR TOWERS PVT.LTD.

OWNER/AUTH. SIGNATURE      ARCHITECT'S SIGNATURE

DRAWING TITLE

6TH FLOOR PLAN

DRAWING NO. 11      SCALE - 1:200

ELEVATION A

2M WIDE REQUIRE

FIRE DOOR ADDED

ELEVATION B

ELEVATION C

ELEVATION D